

COPY RIGHT OF THIS DRAWING BELONGS TO M/S S.S CONSULTANTS AND SHOULD NOT BE USED FOR ANY PURPOSE OTHER THAN SPECIFIED WITHOUT PRIOR PERMISSION.  
NORTH :

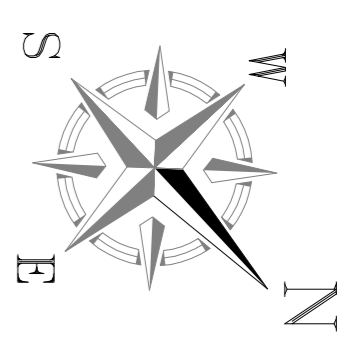

**JOINERY SCHEDULE**

TYPE	NAME	SIZE	GROUND FLOOR	FIRST FLOOR
ALUMINIUM DOORS	ALD1	1800x2100	1	-
WOODEN DOORS	D	1200x2100	6	4
WOODEN DOORS	D1	900x2100	-	1
PRE PAINTED STEEL WINDOWS	PV	1800x1200	52	45
PRE PAINTED STEEL VENTILATOR	PV	900x600	2	3

AREAS :

GROUND FLOOR	1039.93 Sq.m.
FIRST FLOOR	1039.93 Sq.m.
TOTAL	2078.86Sq.m.
PORTICO	87.48 Sq.m.
TOTAL AREA	2166.34 Sq.m.

PROJECT :  
CONSTRUCTION OF NEW MEDICAL COLLEGE WITH ULTRA MODERN FACILITIES AT NIZAMABAD IN NIZAMABAD DIST

TITLE :  
SERVICE BLOCK  
FIRST FLOOR PLAN  
(M.R.D & STORES)

CLIENT :  
TELANGANA MEDICAL SERVICES  
INFRASTRUCTURE DEVELOPMENT CORPORATION  
(An Enterprise of Government of Telangana)  
DM & HS CAMPUS  
SULTAN BAZAR, KOTI, HYDERABAD.

CONSULTANTS :  
**S.S.CONSULTANTS**  
PROJECT CONSULTANTS  
#77&9, JABBAR BUILDINGS,  
BECOMPET, HYDERABAD-16  
PH: 66310240, 66310954,  
FAX NO: 040-66312949,  
emilid: sscons3699@gmail.com

DATE : 30/09/10  
SCALE : 1:100  
DEALT BY : VASAVIN  
ARCHITECT : N.V.SRINIVAS RAO  
CHECKED BY : S.S.RAO

SHEET NO:  
**11**

DRG.NO:SS/SM/SDC/NZB/ SERVICE BLOCK/F./AR-11

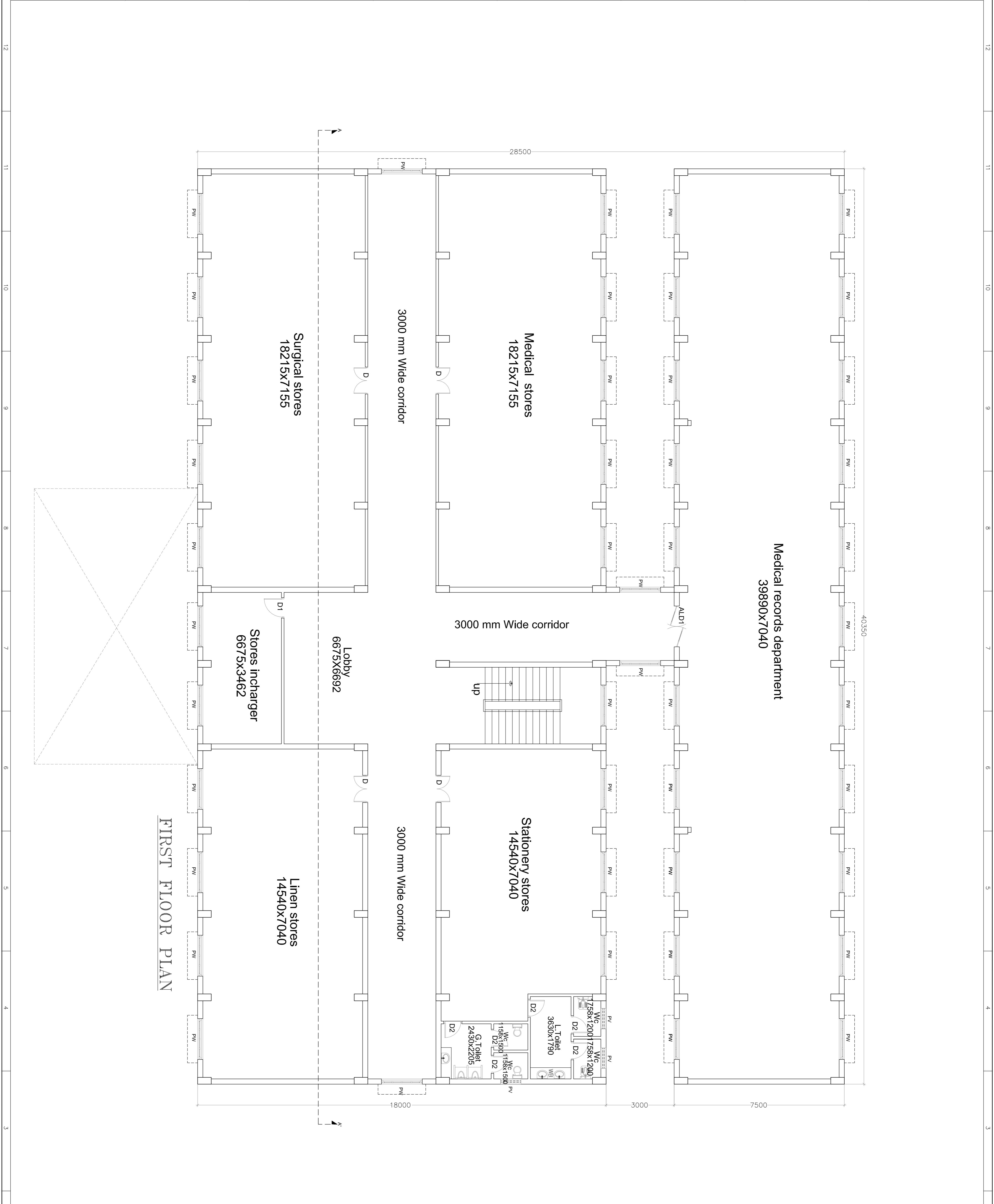

**FIRST FLOOR PLAN**

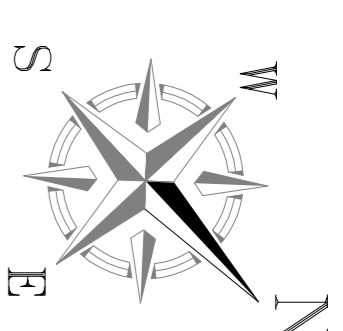

**JOINERY SCHEDULE**

TYPE	NAME	SIZE	GROUND FLOOR	FIRST FLOOR
ALUMINIUM DOORS	ALD	1800x2100	1	-
ALUMINIUM DOORS	ALD1	1800x2100	10	1
WOODEN DOORS	D	1200x2100	6	4
WOODEN DOORS	D1	900x2100	-	1
WOODEN DOORS	D2	900x2100	2	6
PRE PAINTED STEEL WINDOWS	PW	1800x1200	52	45
PRE PAINTED STEEL VENTILATOR	PV	900x600	2	3

AREAS :  
**GROUND FLOOR** 1039.93 Sq.m.  
**FIRST FLOOR** 1039.93 Sq.m.  
**TOTAL** 2078.86Sq.m.

**PORTICO** 87.48 Sq.m.  
**TOTAL AREA** 2166.34 Sq.m.

**PROJECT :**

CONSTRUCTION OF NEW MEDICAL COLLEGE WITH ULTRA MODERN FACILITIES AT NIZAMABAD IN NIZAMABAD DIST

**TITLE :**

SERVICE BLOCK  
 GROUND FLOOR PLAN  
 (MECHANIZED LANDRY) &  
 (KITCHEN CUM DINING)

**CLIENT :**

TELANGANA MEDICAL SERVICES  
 INFRASTRUCTURE DEVELOPMENT CORPORATION  
 (An Enterprise of Government of Telangana)  
 DM & HS CAMPUS  
 SULTAN BAZAR KOTIL, HYDERABAD.

**CONSULTANTS :**

**S.S.CONSULTANTS**  
 PROJECT CONSULTANTS  
 #17&9, JABBAR BULDINGS,  
 BECOMPET, HYDERABAD-16  
 PH: 66310240, 66310934.  
 FAX NO: 040-66312949.  
 email: sscons3599@gmail.com

**DATE :** 30/09/10

**SCALE :** 1:100

**DEALT BY :** VASAVIN

**ARCHITECT :** N.V.SRINIVAS RAO

**CHECKED BY :** S.S.RAO

**GROUND FLOOR PLAN**

