

COPY RIGHT OF THIS DRAWING BELONGS TO M/S S.S CONSULTANTS AND SHOULD NOT BE USED FOR ANY PURPOSE OTHER THAN SPECIFIED WITHOUT PRIOR PERMISSION.

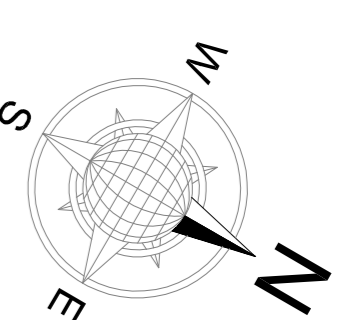

**LEGEND**

TYPE	NAME	SIZE	NOS
WOODEN DOOR	MD1	3000x2800	-
WOODEN DOOR	D2	1500x2800	1
WOODEN DOOR	D3	1200x2800	19
WOODEN DOOR	D4	1000x2800	34
WOODEN DOOR	D5	750x2100	39
ALUMINIUM DOORS	ALD1	1800x2800	7
PRE PAINTED STEEL WINDOWS	W1	1800x1700	69
PRE PAINTED STEEL WINDOWS	W2	1500x1700	-
PRE PAINTED STEEL VENTILATORS	V2	600x500	54
ALUMINIUM SLIDING WINDOWS	ASW1	1500x1700	13

AREAS :

GROUND FLOOR AREA: 2233.00 Sq.Mt.  
 FIRST FLOOR AREA : 2233.00 Sq.Mt.  
 SECOND FLOOR AREA : 2233.00 Sq.Mt.

TOTAL AREA : 6699.00 Sq.Mt.

MAIN PORTICO AREA :112.00 Sq.Mt.  
 EMERGENCY PORTICO AREA :61.00 Sq.Mt.  
 REAR PORTICO AREA :30.00 Sq.Mt.

Status : ARCHITECTURAL WORKING DRAWING

Project : PROPOSED 100 BEDDED HOSPITAL AT PATANCHERU, MEDAK DISTRICT

Title : HOSPITAL BUILDING FIRST FLOOR WORKING PLAN

Client : TELANGANA STATE MEDICAL SERVICES INFRASTRUCTURE DEVELOPMENT CORPORATION (An Enterprise of Government of Telangana) DM & HS CAMPUS SULTAN BAZAR, KOTI, HYDERABAD.

Consultants : S.S.CONSULTANTS

PROJECT CONSULTANTS  
 #17&9, JABBAR BUILDINGS,  
 BEGUMPET, HYDERABAD-16  
 Ph: 66310240, 66310954.  
 FAX NO: 040-66312949.  
 email: ssccons3699@gmail.com

DATE	SCALE	DRAWN BY
20-12-2007	1:125	Ratnaprabha
DESIGNED BY		CHKD.BY

DRG.No.-SS/TSMSTD/PATANCHERU/HOS/F.F/AD-02A

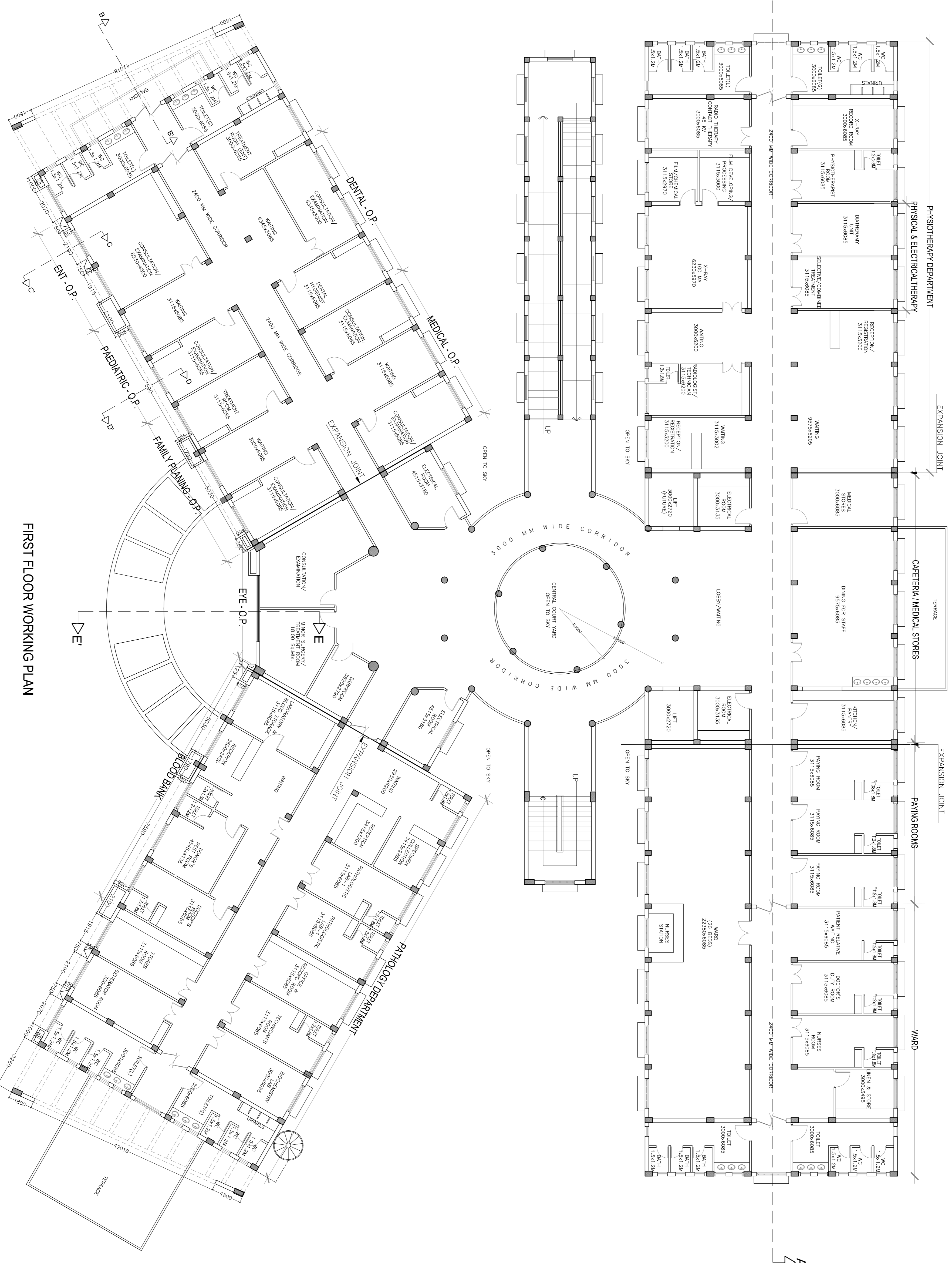

FIRST FLOOR WORKING PLAN

COPY RIGHT OF THIS DRAWING BELONGS TO M/S S.S CONSULTANTS AND SHOULD NOT BE USED FOR ANY PURPOSE OTHER THAN SPECIFIED WITHOUT PRIOR PERMISSION.

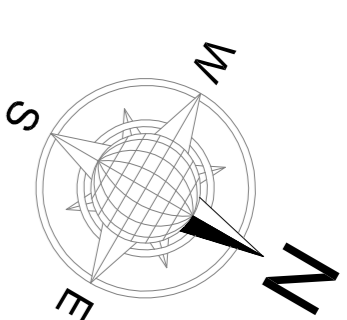

LEGEND		
TYPE	NAME	NO.S
WOODEN DOOR	MD1	3000x2800
WOODEN DOOR	D2	1500x2800
WOODEN DOOR	D3	1200x2800
WOODEN DOOR	D4	1000x2800
WOODEN DOOR	D5	750x2100
ALUMINIUM DOORS	ALD1	1800x2800
PRE PAINTED STEEL WINDOWS	W1	1800x1700
PRE PAINTED STEEL WINDOWS	W2	1500x1700
PRE PAINTED STEEL VENTILATORS	V2	600x500
ALUMINIUM SLIDING WINDOWS	ASW1	1500x1700
		13

Areas :  
**GROUND FLOOR AREA: 2233.00 Sq.Mt.**  
**FIRST FLOOR AREA : 2233.00 Sq.Mt.**  
**SECOND FLOOR AREA : 2233.00 Sq.Mt.**  
**TOTAL AREA : 6699.00 Sq.Mt.**

**MAIN PORTICO AREA :1122.00 Sq.Mt.**  
**EMERGENCY PORTICO AREA :61.00 Sq.Mt.**  
**REAR PORTICO AREA :30.00 Sq.Mt.**

Status : **ARCHITECTURAL WORKING DRAWING**

Project : **PROPOSED 100 BEDDED HOSPITAL AT PATANCHERU, MEDAK DISTRICT**

Title : **HOSPITAL BUILDING SECOND FLOOR WORKING PLAN**

Client : **TELANGANA STATE MEDICAL SERVICES INFRASTRUCTURE DEVELOPMENT CORPORATION (An Enterprise of Government of Telangana) DM & HS CAMPUS SULTAN BAZAR, KOTI, HYDERABAD.**

Consultants : **S.S. CONSULTANTS**

PROJECT CONSULTANTS  
 #17&9, JABBAR BUILDINGS,  
 BEGUMPET, HYDERABAD-16  
 Ph: 66310240, 66310954.  
 FAX NO: 040-66312949.  
 email: sscscons3699@gmail.com

DATE	SCALE	DRAWN BY
20-12-2007	1:125	Ratnaprabha
DESIGNED BY		CHKD.BY

DRG.No.-SS/TSMSSDC/PATANCHERU/HOS/S.F/AD-02B

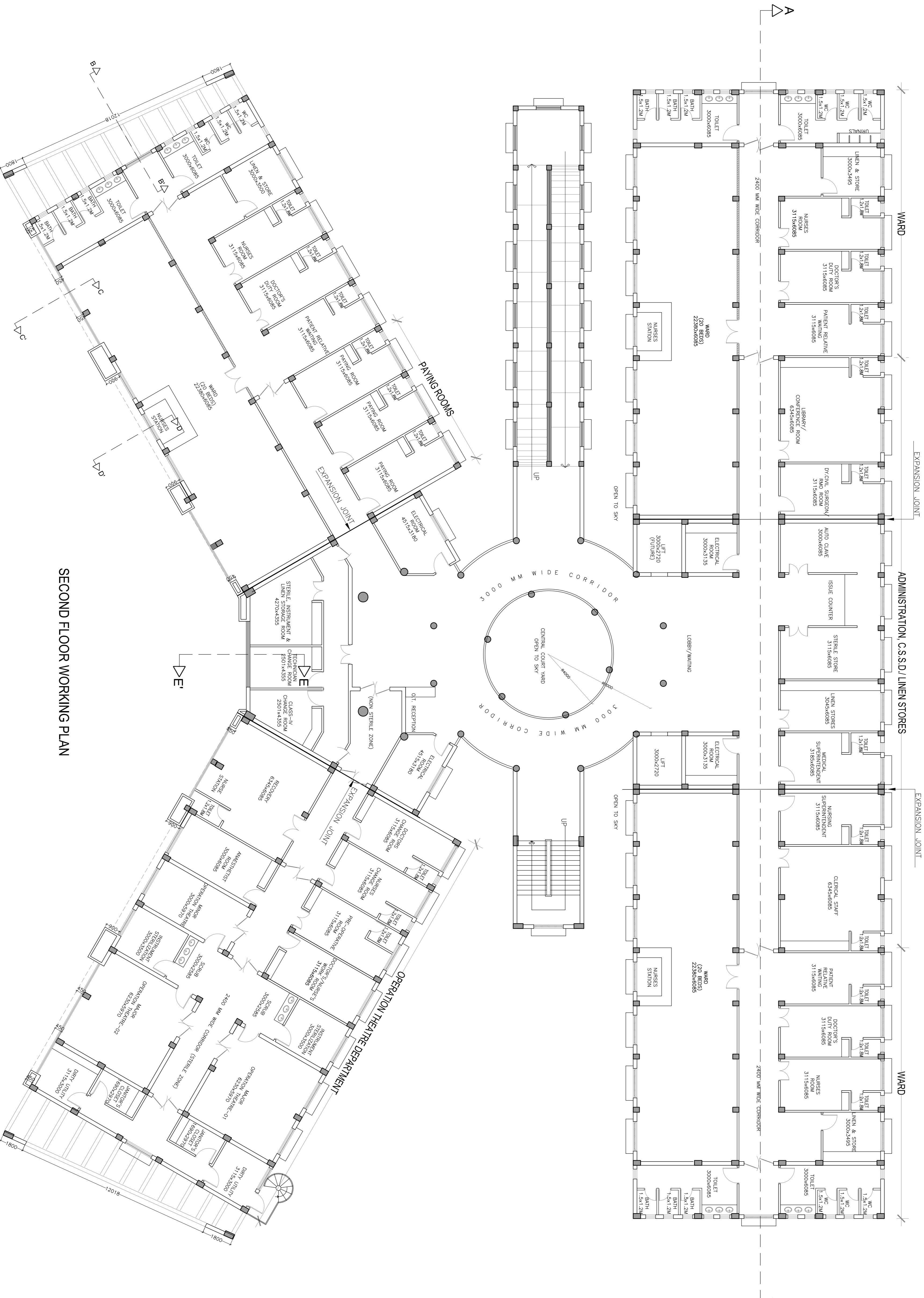

**SECOND FLOOR WORKING PLAN**

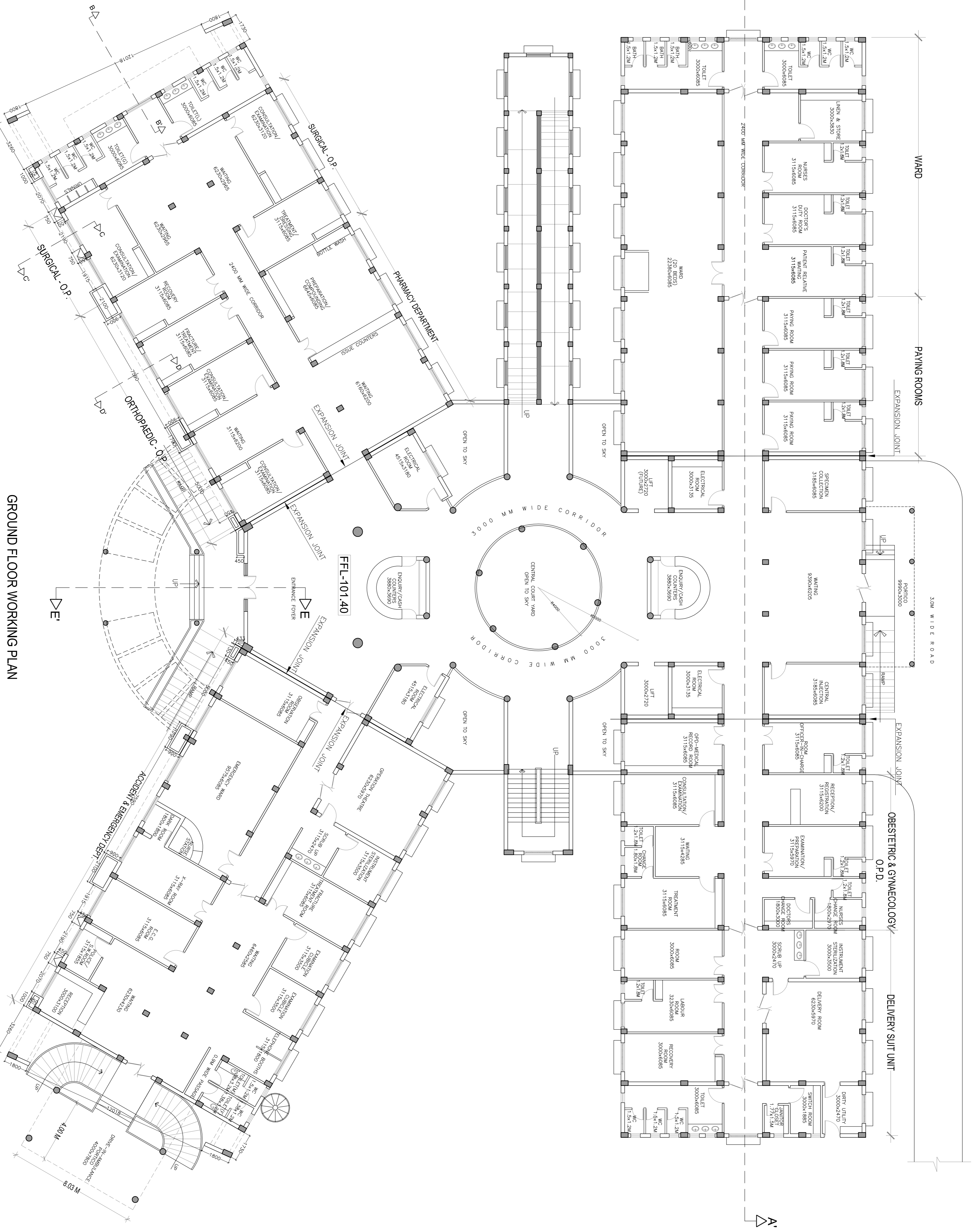

GROUND FLOOR WORKING PLAN

COPY RIGHT OF THIS DRAWING BELONGS TO M/S S.S CONSULTANTS AND SHOULD NOT BE USED FOR ANY PURPOSE OTHER THAN SPECIFIED WITHOUT PRIOR PERMISSION.

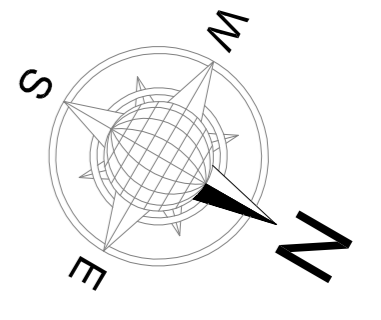

**LEGEND**

TYPE	NAME	SIZE	NOS
WOODEN DOOR	MD1	3000x2800	1
WOODEN DOOR	D2	1500x2800	2
WOODEN DOOR	D3	1200x2800	19
WOODEN DOOR	D4	1000x2800	31
WOODEN DOOR	D5	750x2100	31
ALUMINIUM DOORS	ALD1	1800x2800	11
PRE PAINTED STEEL WINDOWS	W1	1800x1700	65
PRE PAINTED STEEL WINDOWS	W2	1500x1700	1
PRE PAINTED STEEL VENTILATORS	V2	600x500	43
ALUMINIUM SLIDING WINDOWS	ASW1	1500x1700	13

Areas :  
**GROUND FLOOR AREA: 2233.00 Sq.Mt.**  
**FIRST FLOOR AREA : 2233.00 Sq.Mt.**  
**SECOND FLOOR AREA : 2233.00 Sq.Mt.**  
**TOTAL AREA : 6699.00 Sq.Mt.**

**MAIN PORTICO AREA :112.00 Sq.Mt.**  
**EMERGENCY PORTICO AREA :61.00 Sq.Mt.**  
**REAR PORTICO AREA :30.00 Sq.Mt.**

Status : **ARCHITECTURAL WORKING DRAWING**

Project : **PROPOSED 100 BEDDED HOSPITAL AT PATANCHERU, MEDAK DISTRICT**

Title : **HOSPITAL BUILDING GROUND FLOOR WORKING PLAN**

Client : **TELANGANA STATE MEDICAL SERVICES INFRASTRUCTURE DEVELOPMENT CORPORATION (An Enterprise of Government of Telangana) DM & HS CAMPUS SULTAN BAZAR, KOTI, HYDERABAD.**

Consultants  
**S.S CONSULTANTS**  
 PROJECT CONSULTANTS  
 #17&9, JABBAR BUILDINGS,  
 BEGUMPET, HYDERABAD-16  
 Ph: 66310240, 66310954.  
 FAX NO: 040-66312949.  
 email: sscscons3699@gmail.com

DATE	SCALE	DRAWN BY
20-12-2007	1:125	Ratnaprabha
DESIGNED BY		CHKD.BY
DRG.No--SS/TSMIDC/PATANCHERU/HOS/G.F/AD-02		REV.

COPY RIGHT OF THIS DRAWING BELONGS TO M/S S.S CONSULTANTS AND SHOULD NOT BE USED FOR ANY PURPOSE OTHER THAN SPECIFIED WITHOUT PRIOR PERMISSION.

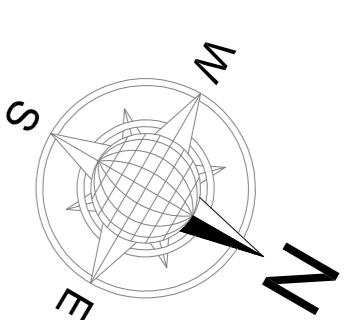

**LEGEND**

TYPE	NAME	SIZE	NOS
WOODEN DOOR	MD1	3000x2800	-
WOODEN DOOR	D2	1500x2800	-
WOODEN DOOR	D3	1200x2800	-
WOODEN DOOR	D4	1000x2800	1
WOODEN DOOR	D5	750x2100	-
ALUMINIUM DOORS	ALD1	1800x2800	-
PRE PAINTED STEEL WINDOWS	W1	1800x1700	1
PRE PAINTED STEEL WINDOWS	W2	1200x1700	-
PRE PAINTED STEEL VENTILATORS	V2	600x500	-
ALUMINIUM SLIDING WINDOWS	ASW1	1500x1700	-

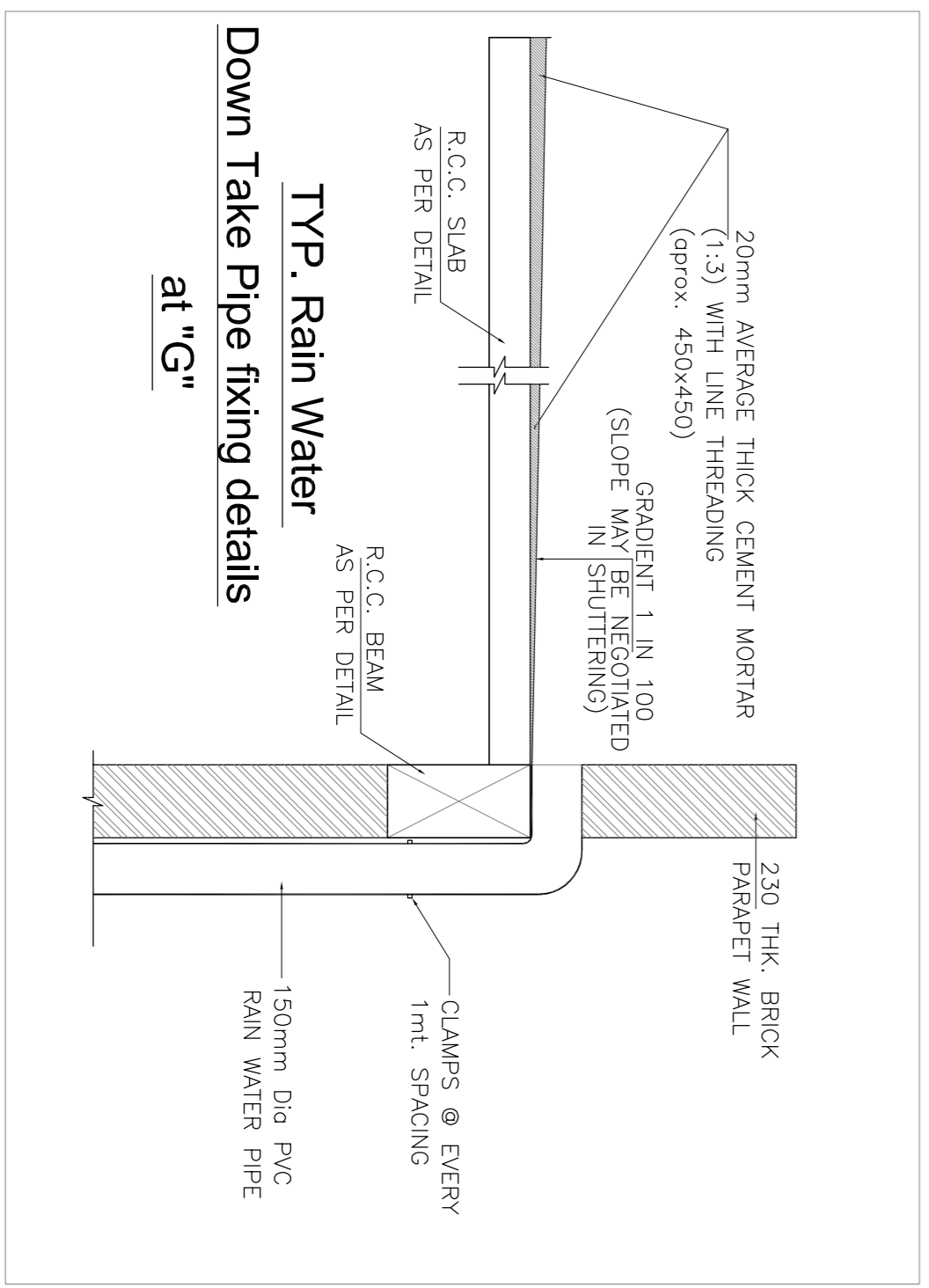
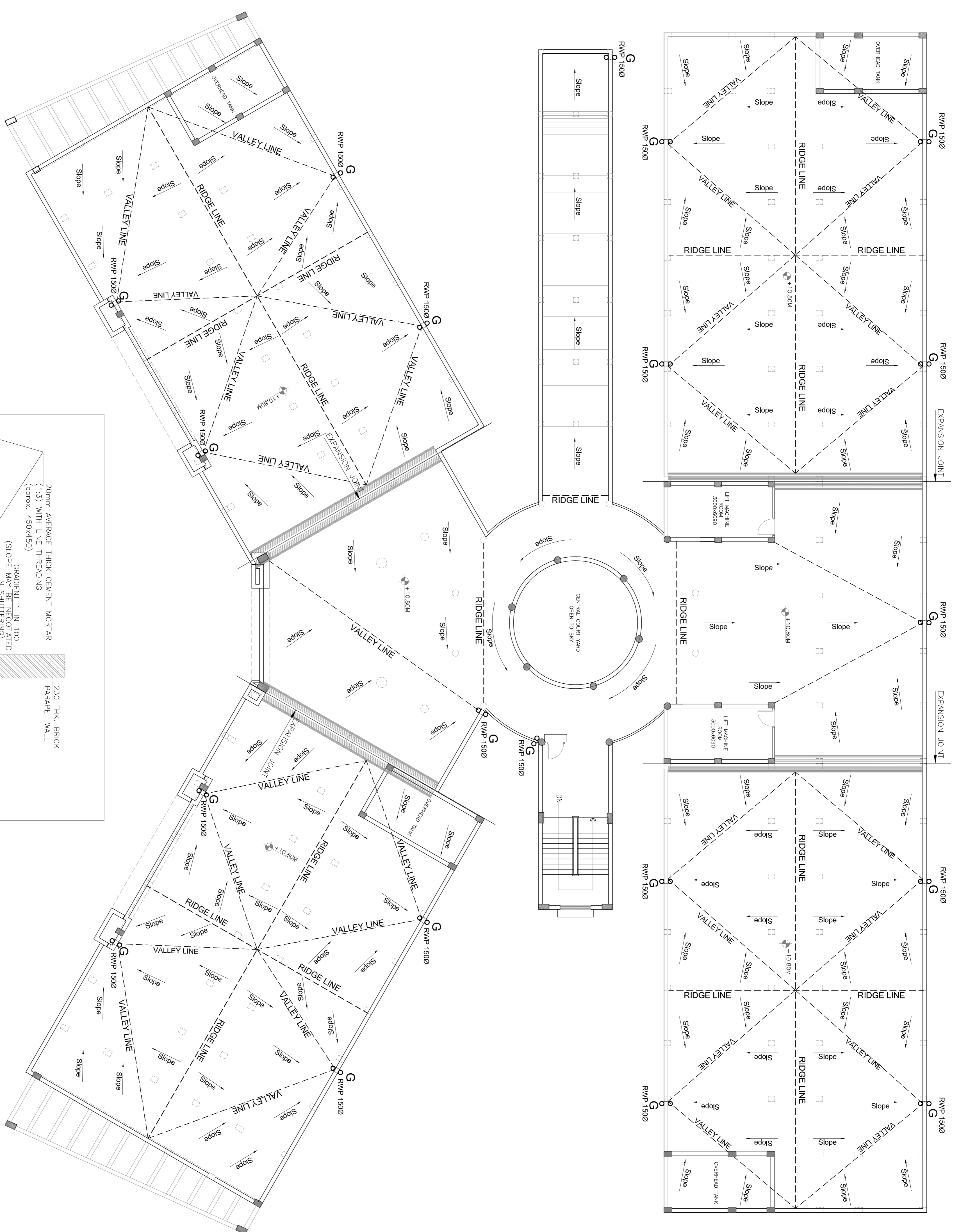

Status : ARCHITECTURAL WORKING DRAWING

Project : PROPOSED 100 BEDDED HOSPITAL AT PATANCHERU, MEDAK DISTRICT

Title : HOSPITAL BUILDING TERRACE FLOOR PLAN

Client : TELANGANA STATE MEDICAL SERVICES INFRASTRUCTURE DEVELOPMENT CORPORATION (An Enterprise of Government of Telangana) DM & HS CAMPUS SULTAN BAZAR, KOTI, HYDERABAD.

Consultants : S.S. CONSULTANTS

PROJECT CONSULTANTS #17&9, JABBAR BUILDINGS, BEGUMPET, HYDERABAD-16 Ph: 66310240, 66310954. FAX NO: 040-66312949. email: ssccons3699@gmail.com

DATE	SCALE	DRAWN BY
19-06-2007	1:125	Ratnaprabha
DESIGNED BY		CHKD.BY

DRG.No--SS/TSMSIDC/PATANCHERU/HOS./T.F./AD--02C