

**CELLAR FLOOR PLAN**

101.481

COPY RIGHT OF THIS DRAWING BELONGS TO M/S. S.S. CONSULTANTS AND SHOULD NOT BE USED FOR ANY PURPOSE OTHER THAN SPECIFIED WITHOUT PRIOR PERMISSION.

**NOTES**

1. ALL DIMENSIONS ARE IN MILLIMETRES, UNLESS OTHERWISE MENTIONED IN DRAWING.

**NORTH :**

JOINERY SCHEDULE		PRE PAINTED STEEL WINDOWS		CURTAIN BLINDS		M.S.SCHEDULE IN CELLAR FLOOR	
NO	DESCRIPTION	QTY	UNIT	NO	DESCRIPTION	QTY	UNIT
W1	1800x2400	1	5	CG1	5500x2175	1	1
W2	1500x2400	1	5	CG2	4500x2175	2	2
W3	1200x2400	1	5	CG3	3000x2175	2	2
W4	1000x2400	1	5	CG4	2000x2175	2	2
W5	900x2400	1	5	CG5	1500x2175	2	2
W6	750x2400	1	5	CG6	1000x2175	2	2
W7	600x2400	1	5	CG7	500x2175	2	2
W8	450x2400	1	5	CG8	250x2175	2	2
W9	300x2400	1	5	CG9	125x2175	2	2
W10	150x2400	1	5	CG10	62.5x2175	2	2
W11	1200x2400	1	5	CG11	1200x2175	2	2
W12	1000x2400	1	5	CG12	1000x2175	2	2
W13	900x2400	1	5	CG13	900x2175	2	2
W14	750x2400	1	5	CG14	750x2175	2	2
W15	600x2400	1	5	CG15	600x2175	2	2
W16	450x2400	1	5	CG16	450x2175	2	2
W17	300x2400	1	5	CG17	300x2175	2	2
W18	150x2400	1	5	CG18	150x2175	2	2
W19	1200x2400	1	5	CG19	1200x2175	2	2
W20	1000x2400	1	5	CG20	1000x2175	2	2
W21	900x2400	1	5	CG21	900x2175	2	2
W22	750x2400	1	5	CG22	750x2175	2	2
W23	600x2400	1	5	CG23	600x2175	2	2
W24	450x2400	1	5	CG24	450x2175	2	2
W25	300x2400	1	5	CG25	300x2175	2	2
W26	150x2400	1	5	CG26	150x2175	2	2
W27	1200x2400	1	5	CG27	1200x2175	2	2
W28	1000x2400	1	5	CG28	1000x2175	2	2
W29	900x2400	1	5	CG29	900x2175	2	2
W30	750x2400	1	5	CG30	750x2175	2	2
W31	600x2400	1	5	CG31	600x2175	2	2
W32	450x2400	1	5	CG32	450x2175	2	2
W33	300x2400	1	5	CG33	300x2175	2	2
W34	150x2400	1	5	CG34	150x2175	2	2
W35	1200x2400	1	5	CG35	1200x2175	2	2
W36	1000x2400	1	5	CG36	1000x2175	2	2
W37	900x2400	1	5	CG37	900x2175	2	2
W38	750x2400	1	5	CG38	750x2175	2	2
W39	600x2400	1	5	CG39	600x2175	2	2
W40	450x2400	1	5	CG40	450x2175	2	2
W41	300x2400	1	5	CG41	300x2175	2	2
W42	150x2400	1	5	CG42	150x2175	2	2
W43	1200x2400	1	5	CG43	1200x2175	2	2
W44	1000x2400	1	5	CG44	1000x2175	2	2
W45	900x2400	1	5	CG45	900x2175	2	2
W46	750x2400	1	5	CG46	750x2175	2	2
W47	600x2400	1	5	CG47	600x2175	2	2
W48	450x2400	1	5	CG48	450x2175	2	2
W49	300x2400	1	5	CG49	300x2175	2	2
W50	150x2400	1	5	CG50	150x2175	2	2

AREAS		CELLAR FLOOR AREA	
NO	DESCRIPTION	AREA (Sq.m)	TOTAL
1	CELLAR FLOOR AREA	1218.00	1218.00
2	SUB CELLAR FLOOR AREA	1255.00	2473.00
3	GROUND FLOOR PLAN	1200.00	1200.00
4	FIRST FLOOR PLAN	1200.00	1200.00
5	SECOND FLOOR PLAN	1200.00	1200.00
6	THIRD FLOOR PLAN	1200.00	1200.00
7	FOURTH FLOOR PLAN	910.00	910.00
8	TOTAL	5710.00	5710.00
9	PORTICO AREA	+2473.00	8183.00
10			70.00

NO	REV	DATE	DESCRIPTION	CHKD BY	REFERENCE
1					

Project : **PROPOSED CONSTRUCTION OF GOLDEN JUBILEE BLOCK IN THE PREMISES OF MNU INSTITUTE OF ONCOLOGY & REGIONAL CANCER CENTRE AT RED HILLS, HYDERABAD**

Architectural Working Drawing

Title : **PLAN OF GOLDEN JUBILEE BLOCK CELLAR FLOOR PLAN**

Client : **ANDHRA PRADESH HEALTH & MEDICAL HOUSING & INFRASTRUCTURE DEVELOPMENT CORPORATION, APJANUC BUILDING, DM & HS CAMPUS, SILTUN BAZAR, KOTI, HYDERABAD, ANDHRA PRADESH - 500095.**

Consultants		S.S. CONSULTANTS	
DATE	SCALE	DESIGNED BY	CHKD BY
10-01-2017	N.T.S	MNS	LAKSHMI
PROJECT CONSULTANTS		#17&9, JAGBARI BUILDINGS, BECOMPET, HYDERABAD-16	
PH. 55310240, 55310994.		FAX. NO. 040-55312949.	
email: sscs@ssconsultants.com		email: sscs@ssconsultants.com	
DRG. NO. - SS/AR/HR/HC/JANU/REDDHILLS/GOLDEN/AR-01 A		2	

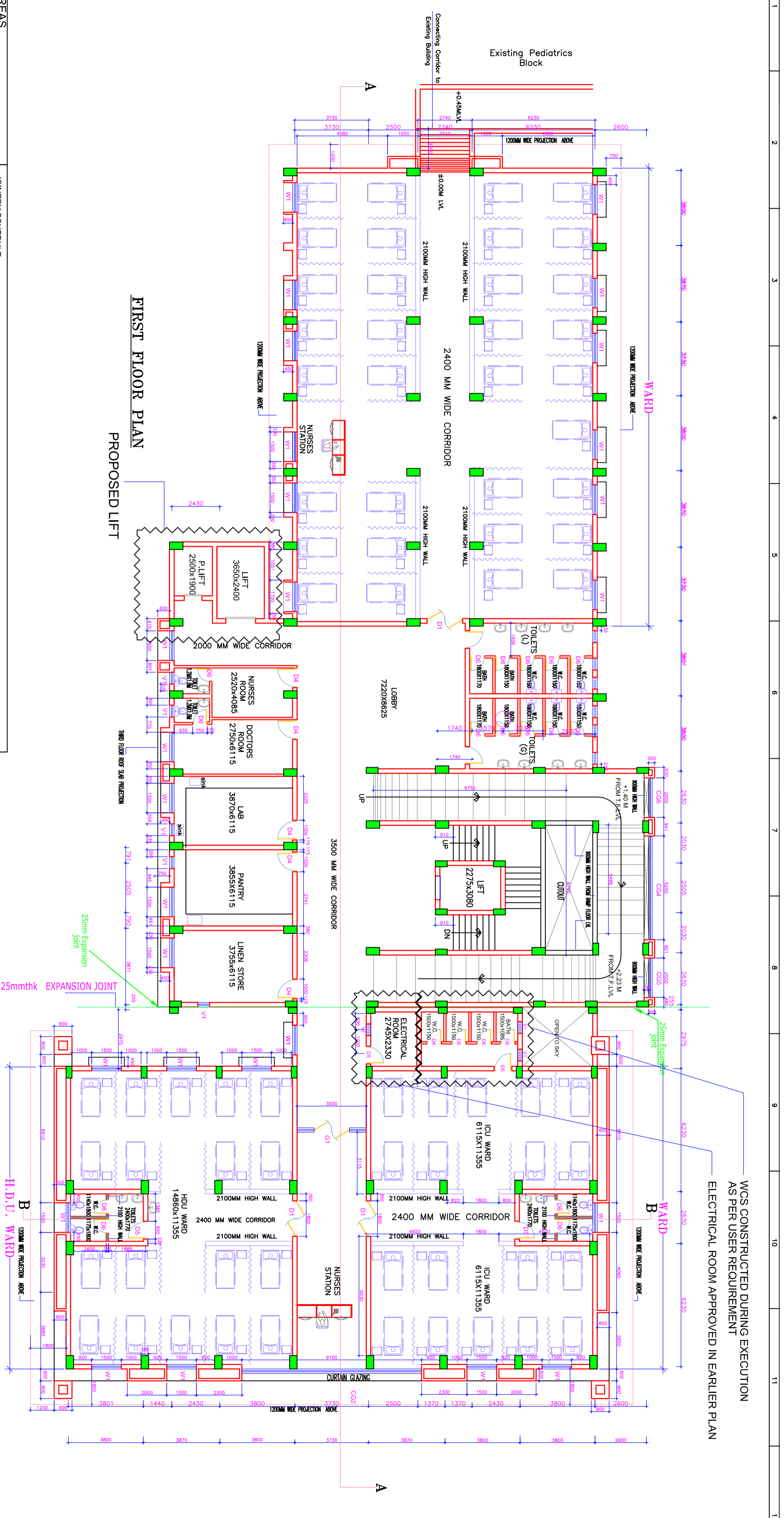

**FIRST FLOOR PLAN**  
**PROPOSED LIFT**

WCS CONSTRUCTED DURING EXECUTION  
AS PER USER REQUIREMENT  
ELECTRICAL ROOM APPROVED IN EARLIER PLAN

AREAS		JOINERY SCHEDULE		PRE PAINTED STEEL WINDOWS		CURTAIN GLAZING	
FLOOR	BUILT UP AREA	WOODEN DOORS	CF	GF	GF	GF	GF
CELLAR FLOOR AREA	1218.00 Sq.m	D1	1500X1700	1	CG1A	3500X3175	1
SUB CELLAR FLOOR AREA	1255.00 Sq.m	D2	1500X2600	1	CG1B	2420X2945	2
TOTAL BASEMENT AREA	2473.00 Sq.m	D3	1200X2600	1	CG2	9100X8900	1
GROUND FLOOR PLAN	1200.00 Sq.m	D4	1000X2600	1	CG3	9100X1700	2
FIRST FLOOR PLAN	1200.00 Sq.m	D5	900X2100	6	CG4	3250X12050	1
SECOND FLOOR PLAN	1200.00 Sq.m	D6	750X2100	8	CG5	2000X12050	1
THIRD FLOOR PLAN	1200.00 Sq.m				CG6	2000X12890	1
FOURTH FLOOR PLAN	1200.00 Sq.m						
TOTAL	6000.00 Sq.m						
PORTICO AREA	8473.00 Sq.m						
	70.00 Sq.m						

COPY RIGHT OF THIS DRAWING BELONGS TO M/S S.S CONSULTANTS  
AND SHOULD NOT BE USED FOR ANY PURPOSE OTHER THAN SPECIFIED  
WITHOUT PRIOR PERMISSION.

PROJECT : **WORKING DRAWINGS**

STATUS : **WORKING DRAWINGS**

CLIENT : **TELANGANA MEDICAL SERVICES**  
**INFRASTRUCTURE DEVELOPMENT CORPORATION**  
(An Enterprise of Government of Telangana)  
DM & HS CAMPUS  
SULTAN BAZAR, KOTI, HYDERABAD.

CELLAR FLOOR AREA		WOODEN DOORS		PRE PAINTED STEEL WINDOWS		CURTAIN GLAZING	
FLOOR	BUILT UP AREA	NAME	SIZE	CF	GF	GF	GF
CELLAR FLOOR AREA	1218.00 Sq.m	D1	1500X1700	1	CG1A	3500X3175	1
SUB CELLAR FLOOR AREA	1255.00 Sq.m	D2	1500X2600	1	CG1B	2420X2945	2
TOTAL BASEMENT AREA	2473.00 Sq.m	D3	1200X2600	1	CG2	9100X8900	1
GROUND FLOOR PLAN	1200.00 Sq.m	D4	1000X2600	1	CG3	9100X1700	2
FIRST FLOOR PLAN	1200.00 Sq.m	D5	900X2100	6	CG4	3250X12050	1
SECOND FLOOR PLAN	1200.00 Sq.m	D6	750X2100	8	CG5	2000X12050	1
THIRD FLOOR PLAN	1200.00 Sq.m				CG6	2000X12890	1
FOURTH FLOOR PLAN	1200.00 Sq.m						
TOTAL	6000.00 Sq.m						
PORTICO AREA	8473.00 Sq.m						
	70.00 Sq.m						

PROPOSED CONSTRUCTION OF  
GOLDEN JUBILEE BLOCK IN THE PREMISES OF  
MNU INSTITUTE OF ONCOLOGY &  
REGIONAL CANCER CENTRE  
AT RED HILLS, HYDERABAD

TITLE : **PLAN OF GOLDEN JUBILEE BLOCK**  
**FIRST FLOOR PLAN**

DATE : 10.11.16  
SCALE : N.T.S  
DESIGNED BY : S.Parameshwari  
CHECKED BY : S.S. RAO

SHEET NO: **02**

CONSULTANTS : **S.S. CONSULTANTS**  
PROJECT CONSULTANTS  
#17&9, JABBAR BUILDINGS,  
BEGLUMPET, HYDERABAD-16  
PH: 66310240, 66310954,  
FAX NO: 040-66312949.  
emil: sscnss5699@gmail.com

DRG.NO:- SS/TMSIDC/MNU/REDHILLS/GOLDEN/1st.FAR-02

**NOTE:**  
1 AS PER SITE CONDITIONS THERE ARE TOILETS ADJACENT TO RAMP  
WHICH WAS EXECUTED AS PER USER DEPT. REQUIREMENT.  
2 D.E.E. ASKED TO PROVIDE LIFTS AS PER USER DEPT.  
REQUIREMENT. THE SAME IS INCORPORATED IN ALL FLOORS  
AT GRIDS 6C & 7C



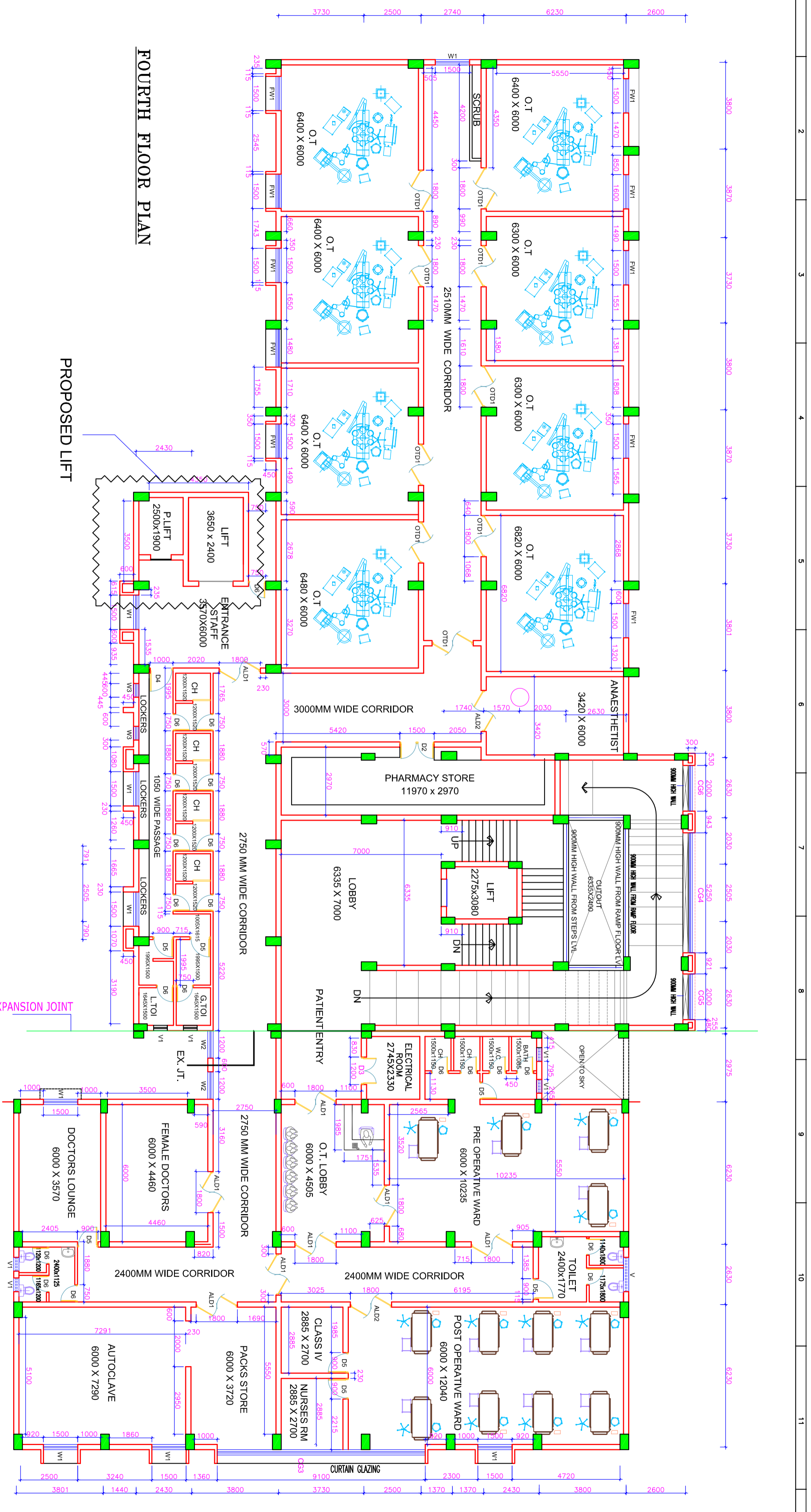

**FOURTH FLOOR PLAN**

**PROPOSED LIFT**

25mmthk EXPANSION JOINT

AREAS		JOINERY SCHEDULE		PRE-PAINTED STEEL WINDOWS		CURTAIN GLAZING	
FLOOR	BUILDUP AREA	NAME	SIZE	QTY	UNIT	NAME	SIZE
G	CELLAR FLOOR AREA	D1	12180x2600	1	1	CG1A	3600x3175
	SUB CELLAR FLOOR AREA	D2	12550x2600	1	2	CG1B	3600x2945
	TOTAL BASEMENT AREA	D3	247300 Sqm	11	11	CG2	9100x9800
	GROUND FLOOR PLAN	D4	12000.00 Sqm	11	11	CG3	9100x1700
E	FIRST FLOOR PLAN	D5	12000.00 Sqm	13	13	CG4	3250x1250
	SECOND FLOOR PLAN	D6	12000.00 Sqm	6	6	CG5	2000x1250
	THIRD FLOOR PLAN	D7	12000.00 Sqm	8	8	CG6	2000x1250
	FOURTH FLOOR PLAN	D8	12000.00 Sqm	16	16	CG7	2000x1250
D	TOTAL	D9	60000.00 Sqm	62	62	V	1500x800
	PORTICO AREA	D10	4247300 Sqm	847	847	V1	900x800

COPY RIGHT OF THIS DRAWING BELONGS TO M/S S.S CONSULTANTS AND SHOULD NOT BE USED FOR ANY PURPOSE OTHER THAN SPECIFIED WITHOUT PRIOR PERMISSION.

**PROJECT :**

**STATUS :**

**CLIENT :**

**DATE :**

**SHEET NO.:**

**CONSULTANTS :**

**PROPOSED CONSTRUCTION OF GOLDEN JUBILEE BLOCK IN THE PREMISES OF MNU INSTITUTE OF ONCOLOGY & REGIONAL CANCER CENTRE AT RED HILLS, HYDERABAD**

**ARCHITECTURAL WORKING DRAWING**  
**TITLE :**  
**PLAN OF GOLDEN JUBILEE BLOCK PROPOSED FOURTH FLOOR PLAN**  
**MODULAR O.T.S 8.0NOS**

**TELANGANA MEDICAL SERVICES INFRASTRUCTURE DEVELOPMENT CORPORATION**  
 (An Enterprise of Government of Telangana)  
 DM & HS CAMPUS  
 SULTAN BAZAR, KOTI, HYDERABAD.

**APPROVED**  
 AD/- DT: 09.10.2017  
 CHIEF ENGINEER (TMSIDC)  
 HYDERABAD

**NOTE:**  
 ONLY PERIPHERAL WALLS FOR MODULAR O.T.S EXTERNAL & INTERNAL BRICKWORK TO BE IN LIGHT WEIGHT BRICKS WITH UNIT WT. NOT MORE THAN 10 KN/M<sup>2</sup>  
 1 AS PER SITE CONDITIONS THERE ARE TOILETS ADJACENT TO RAMP WHICH WAS EXECUTED AS PER USER DEPT. REQUIREMENT.  
 2 D.E. ASKED TO PROVIDE LIFTS AS PER USER DEPT. REQUIREMENT. THE SAME IS INCORPORATED IN ALL FLOORS AT GRIDS 6C & 7C

**05**

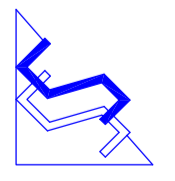

**S.S. CONSULTANTS**

PROJECT CONSULTANTS  
 #17&9, JABBAR BUILDINGS,  
 BEJAMPET, HYDERABAD-16  
 PH: 66310240, 66310954,  
 FAX NO: 040-66312949.  
 emdil: sscnss3699@gmail.com

DRG.NO:- SS/TMSIDC/MNU/REDHILLS/GOLDEN4TH.F/AR-05

EXISTING G+1 BUILDING

ANCILLARY SERVICES

SURGICAL ONCOLOGY O.P.D.

ELECTRICAL ROOM APPROVED IN EARLIER PLAN

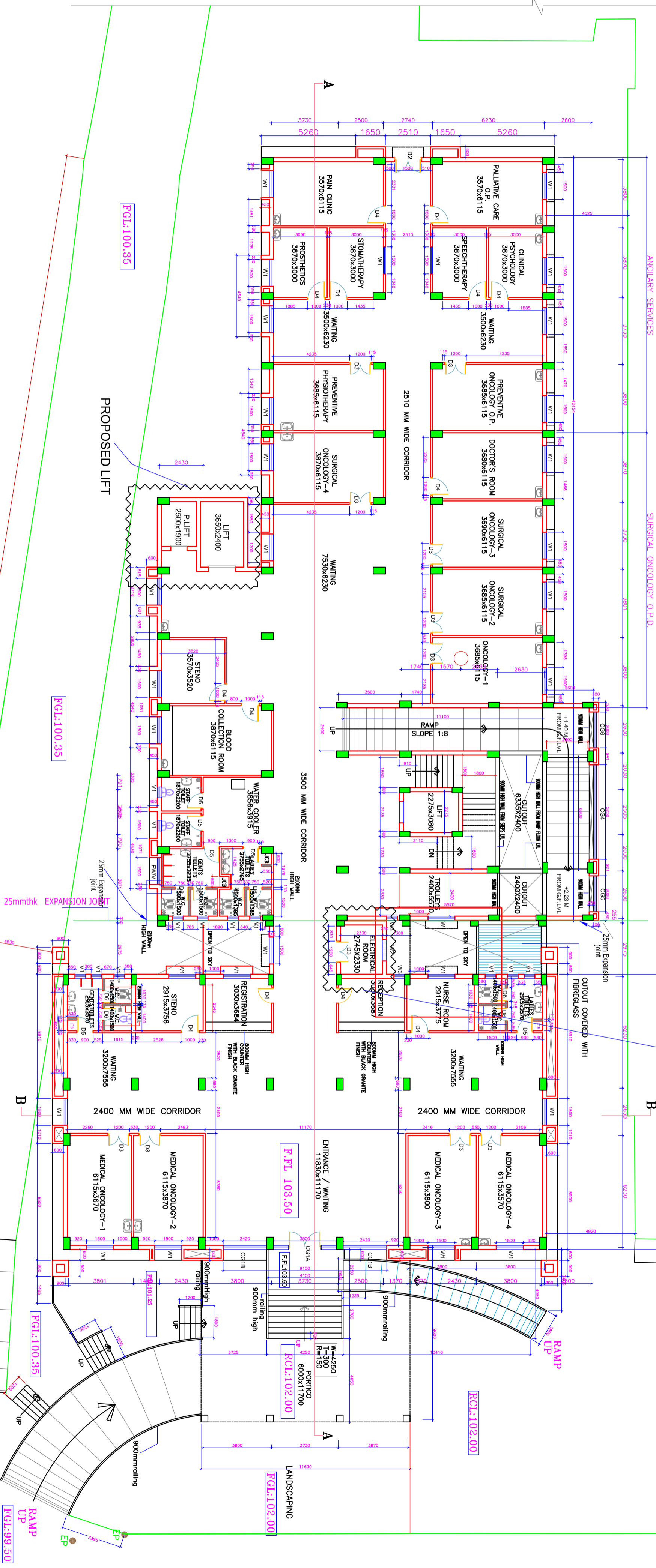

PROPOSED LIFT

25mmthk EXPANSION JOINT

ROAD

RAMP

RAMP UP

**AREAS**

FLOOR	BUILDUP AREA	IONERARY SCHEDULE	PRE-FINISHED STEEL WINDOWS	GLAZING
CELLAR FLOOR AREA	1218.00 Sq.m	W1	1500X1700	CG1A
SUB CELLAR FLOOR AREA	1255.00 Sq.m	D1	1500X1700	CG1B
TOTAL BASEMENT AREA	2473.00 Sq.m	D2	1500X1700	CG1B
GROUND FLOOR PLAN	1200.00 Sq.m	D3	1500X1700	CG2
FIRST FLOOR PLAN	1200.00 Sq.m	D4	1500X1700	CG3
SECOND FLOOR PLAN	1200.00 Sq.m	D5	1500X1700	CG4
THIRD FLOOR PLAN	1200.00 Sq.m	D6	1500X1700	CG5
FOURTH FLOOR PLAN	1200.00 Sq.m	D7	1500X1700	CG6
TOTAL	6000.00 Sq.m			
PORTICO AREA	4273.00 Sq.m			

**NOTE:**

- AS PER SITE CONDITIONS THERE ARE TOILETS ADJACENT TO RAMP WHICH WAS EXECUTED AS PER USER DEPT. REQUIREMENT.
- D.I.E. ASKED TO PROVIDE LIFTS AS PER USER DEPT. REQUIREMENT. THE SAME IS INCORPORATED IN ALL FLOORS AT GRIDS 6C & 7C

**PROJECT :**

**STATUS :** WORKING DRAWINGS

**CLIENT :** TELANGANA MEDICAL SERVICES  
INFRASTRUCTURE DEVELOPMENT CORPORATION  
(An Enterprise of Government of Telangana)  
DM & HS CAMPUS  
SULTAN BAZAR, KOTI, HYDERABAD.

**DATE :** 10.11.16

**SCALE :** N.T.S

**DESIGNED BY :** N.V.SRINIVAS RAO

**CHECKED BY :** S.S. RAO

**CONSULTANTS :**

**S.S. CONSULTANTS**

PROJECT CONSULTANTS  
#17&9, JABBAR BUILDINGS,  
BEGLURPET, HYDERABAD-16  
PH: 66310240, 66310954,  
FAX NO: 040-66312949.  
emil: sscnons3699@gmail.com

COPY RIGHT OF THIS DRAWING BELONGS TO M/S S & S CONSULTANTS  
AND SHOULD NOT BE USED FOR ANY PURPOSE OTHER THAN SPECIFIED  
WITHOUT PRIOR PERMISSION.

**PROPOSED CONSTRUCTION OF  
GOLDEN JUBILEE BLOCK IN THE PREMISES OF  
MNU INSTITUTE OF ONCOLOGY &  
REGIONAL CANCER CENTRE  
AT RED HILLS, HYDERABAD**

**TITLE :**  
PLAN OF GOLDEN JUBILEE BLOCK  
GROUND FLOOR PLAN

**WORKING DRAWINGS**

**DATE :** 10.11.16

**SCALE :** N.T.S

**DESIGNED BY :** N.V.SRINIVAS RAO

**CHECKED BY :** S.S. RAO

**CONSULTANTS :**

**S.S. CONSULTANTS**

PROJECT CONSULTANTS  
#17&9, JABBAR BUILDINGS,  
BEGLURPET, HYDERABAD-16  
PH: 66310240, 66310954,  
FAX NO: 040-66312949.  
emil: sscnons3699@gmail.com

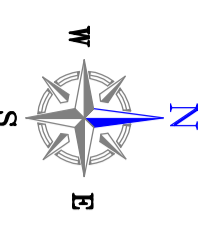

**PROPOSED CONSTRUCTION OF  
GOLDEN JUBILEE BLOCK IN THE PREMISES OF  
MNU INSTITUTE OF ONCOLOGY &  
REGIONAL CANCER CENTRE  
AT RED HILLS, HYDERABAD**

**TITLE :**  
PLAN OF GOLDEN JUBILEE BLOCK  
GROUND FLOOR PLAN

**WORKING DRAWINGS**

**DATE :** 10.11.16

**SCALE :** N.T.S

**DESIGNED BY :** N.V.SRINIVAS RAO

**CHECKED BY :** S.S. RAO

**CONSULTANTS :**

**S.S. CONSULTANTS**

PROJECT CONSULTANTS  
#17&9, JABBAR BUILDINGS,  
BEGLURPET, HYDERABAD-16  
PH: 66310240, 66310954,  
FAX NO: 040-66312949.  
emil: sscnons3699@gmail.com

DRG.NO:- SS/TMS/IDC/MNU/REDHILLS/GOLDEN/G.F/AR-01

PROJECT :

PROPOSED SITE LAY-OUT SHOWING GOLDEN JUBILEE BLOCK & SERVICES BLOCK

SITE AREA :

SITE AREA :12846.94 Sq.mt  
or 15364.81 Sq.yd  
3.175 Acre

EXISTING & PROPOSED BUILDINGS

S.No	BUILDING	STAGE	Total Floor Wise Areas in sq.mts.							
			Sub cellar	Cellar.Floor	G.Floor	1st.Floor	2nd.Floor	3rd.Floor	4th.Floor	Total Area
01	BUILDING EXISTING	EXISTING	----	----	792.28 Sq.mt.	792.28 Sq.mt.	792.28 Sq.mt.	792.28 Sq.mt.	----	3169.12 Sq.mt.
02	LINEAR ACCELERATORS	EXISTING	----	----	487.88 Sq.mt.	487.88 Sq.mt.	----	----	----	975.76 Sq.mt.
03	HOSPITAL MAIN BUILDING	EXISTING	----	----	2840.16 Sq.mt.	2840.16 Sq.mt.	----	----	----	5680.32 Sq.mt.
04	PROPOSED GOLDEN JUBILEE BLOCK THIRD & FOURTH FLOORS	PROPOSED	1255.00 Sq.mt.	1218.00 Sq.mt.	1200.00 Sq.mt.	1200.00 Sq.mt.	1200.00 Sq.mt.	1200.00 Sq.mt.	1200.00 Sq.mt.	7273.00 Sq.mt.
05	PROPOSED SERVICES BLOCK	PROPOSED	----	----	378.15 Sq.mt.	415.27 Sq.mt.	415.27 Sq.mt.	----	----	1208.69 Sq.mt.



**LEGEND:**

S/N	BUILDING	STAGE	Sub ceiling	Cellar Floor	G. Floor	1st Floor	2nd Floor	3rd Floor	4th Floor	Total Area
01	BUILDING EXISTING	EXISTING	---	---	782.28 Sq.m	782.28 Sq.m	782.28 Sq.m	782.28 Sq.m	---	3189.12 Sq.m
02	LINEAR ACCELERATORS	EXISTING	---	---	467.28 Sq.m	467.28 Sq.m	---	---	---	934.56 Sq.m
03	HOSPITAL MAIN BUILDING	EXISTING	---	---	2540.18 Sq.m	2540.18 Sq.m	---	---	---	5080.36 Sq.m
04	PROPOSED GOLDEN JUBILEE BLOCK	PROPOSED	1255.00 Sq.m	1218.00 Sq.m	1200.00 Sq.m	1200.00 Sq.m	1200.00 Sq.m	1200.00 Sq.m	1200.00 Sq.m	7233.00 Sq.m
05	PROPOSED SERVICES BLOCK	PROPOSED	---	---	---	---	---	---	---	1208.00 Sq.m

**Total Floor Wise Areas in sq.mts.**

**NORTH:**

**LEGEND**

PROPOSED BLOCKS

EXISTING BLOCKS

**AREA STATEMENT**

**SITE AREA :12846.94 Sq.mt**  
or 15364.81 Sq.yd  
3.175 Acre

**TITLE :** PROPOSED SITE LAY-OUT SHOWING GOLDEN JUBILEE BLOCK & SERVICES BLOCK

**CLIENT :** MNU INSTITUTE OF ONCOLOGY & REGIONAL CANCER CENTRE AT RED HILLS, HYDERABAD

**CONSULTANTS :** S.S.INFRASTRUCTURE PROJECT CONSULTANTS PVT.LTD.  
# 25 & 9, JABBAR BUILDINGS, BEGUMPET, HYDERABAD-16  
Ph: +91 40 66310964, 66310240  
FAX No: +91 40 66312949.  
email: sspcp@gmail.com

**DATE:** 17-09-2016

**SCALE:** N.T.S

**DEALT BY:** MOJIN

**DESIGNED BY:** B.V.RAMANA

**CHECKED BY:** S.S.RAO

**SHEET NO**

**01**

DRG.NO.: SS/ TMS/DC/ MNU/ REDHILLS / SITE PLAN/ 01





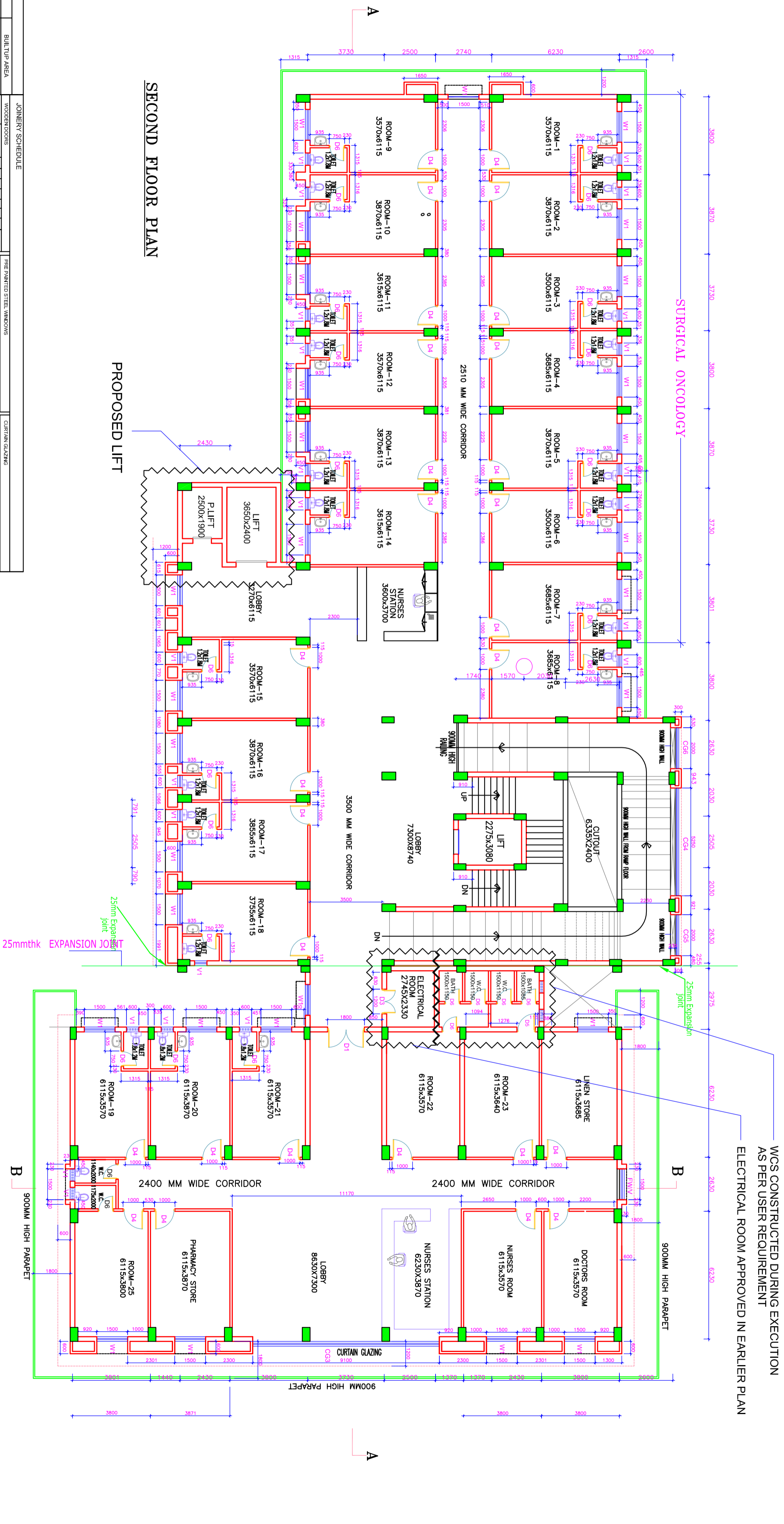

**SECOND FLOOR PLAN**

**PROPOSED LIFT**

AREAS		BUILTUP AREA	
CELLAR FLOOR AREA	1218.00 Sq.m		
SUB CELLAR FLOOR AREA	1255.00 Sq.m		
TOTAL BASEMENT AREA	2473.00 Sq.m		
GROUND FLOOR PLAN	1200.00 Sq.m		
FIRST FLOOR PLAN	1200.00 Sq.m		
SECOND FLOOR PLAN	1200.00 Sq.m		
THIRD FLOOR PLAN	1200.00 Sq.m		
FOURTH FLOOR PLAN	910.00 Sq.m		
TOTAL	5710.00 Sq.m		
PORTICO AREA	4272.00 Sq.m		
	70.00 Sq.m		

JOINERY SCHEDULE		WOODEN DOORS	
NAME	SIZE	Cd	Qt
D1	1800x2800	1	5
D2	1500x2800	1	2
D3	1200x2800	1	1
D4	1000x2800	1	1
D5	900x2100	6	9
D6	750x2100	8	7
ALUMINIUM DOORS			
NAME	SIZE	Cd	Qt
AW1	1900X1700	1	1
AW2	1200X1700	1	1
AW3	600X1700	2	1
AW4	9250X2810	1	1
AW5	2000X2800	1	1
ALUMINIUM SLIDING WINDOWS			
NAME	SIZE	Cd	Qt
W1	1900X1700	30	18
W2	1200X1700	1	1
W3	600X1700	2	1
W4	9250X2810	1	1
W5	2000X2800	1	1
PRE PAINTED STEEL WINDOWS			
NAME	SIZE	Cd	Qt
W6	3000X2800	1	1
W7	1500X2800	5	3
W8	800X2800	12	9

CURTAIN GLAZING		CURTAIN GLAZING	
NAME	SIZE	Cd	Qt
CG1	3650X2400	1	1
CG2	3650X2400	2	1
CG3	9100X1700	1	1
CG4	3250X1950	1	1
CG5	3000X1950	1	1
CG6	3000X1780	1	1
PRE PAINTED STEEL VENTILATORS			
NAME	SIZE	Cd	Qt
V1	1500X2800	5	3
V2	800X2800	12	9

PROJECT :		STATUS :	
1	2	1	2
3	4	5	6
7	8	9	10
11	12	13	14

**PROPOSED CONSTRUCTION OF GOLDEN JUBILEE BLOCK IN THE PREMISES OF MAIN INSTITUTE OF ONCOLOGY & REGIONAL CANCER CENTRE AT RED HILLS, HYDERABAD**

**WORKING DRAWINGS**

**TITLE :**  
PLAN OF GOLDEN JUBILEE BLOCK  
PROPOSED SECOND FLOOR PLAN  
(PROPOSED BRICKWORK ON EXISTING FLOOR)

**CLIENT :**  
TELANGANA MEDICAL SERVICES  
INFRASTRUCTURE DEVELOPMENT CORPORATION  
(An Enterprise of Government of Telangana)  
DM & HS CAMPUS  
SUL TAN BAZAR, KOTI, HYDERABAD.

**DATE :** 10.11.16  
**SCALE :**  
**DESIGNED BY :** S.Parameshwari  
**CHECKED BY :** N.V.SRINIVAS RAO  
S.S. RAO

**SHEET NO. 03**

**CONSULTANTS :**  
**S.S. CONSULTANTS**  
PROJECT CONSULTANTS  
#17&9, JABBAR BUILDINGS,  
BEGLUPEI, HYDERABAD-16  
PH: 66310240, 66310954,  
FAX NO: 040-66312949.  
emil: sscnss5699@gmail.com

**NOTE:**  
1 AS PER SITE CONDITIONS THERE ARE TOILETS ADJACENT TO RAMP WHICH WAS EXECUTED AS PER USER DEPT. REQUIREMENT.  
2 D.E. ASKED TO PROVIDE LIFTS AS PER USER DEPT. REQUIREMENT. THE SAME IS INCORPORATED IN ALL FLOORS AT GRIDS 6C & 7C

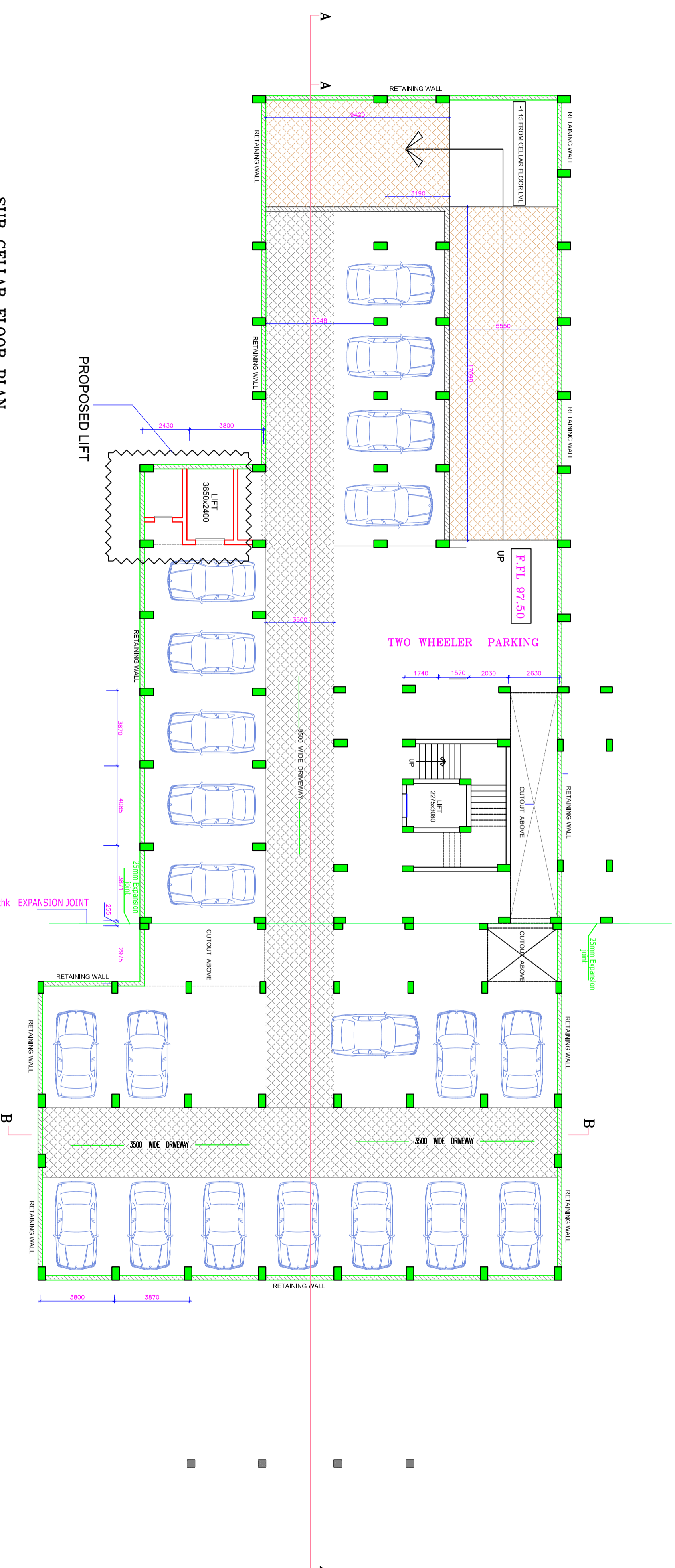

**SUB CELLAR FLOOR PLAN**

COPY RIGHT OF THIS DRAWING BELONGS TO M/S. S.S. CONSULTANTS AND SHOULD NOT BE USED FOR ANY PURPOSE OTHER THAN SPECIFIED WITHOUT PRIOR PERMISSION.

**NOTES**

1. ALL DIMENSIONS ARE IN MILLIMETRES, UNLESS OTHERWISE MENTIONED IN DRAWING.

**NORTH :**

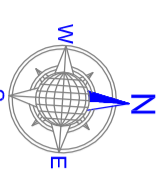

JOINERY SCHEDULE										
NO	NAME	SIZE	C.F.	G.F.	1ST FLOOR	2ND FLOOR	3RD FLOOR	4TH FLOOR	5TH FLOOR	6TH FLOOR
D1	1800x6600	1500x6600	1	5	5	2	13			
D2	1500x6600	1100x6600	2	2	2	2	2			
D3	1200x6600	1100x6600	1	1	1	1	1			
D4	1000x6600	1300x6600	1	1	1	1	1			
D5	900x6600	1100x6600	1	1	1	1	1			
D6	750x6600	1100x6600	1	1	1	1	1			
ALUMINIUM DOORS										
D7	1800x6600	1500x6600	1	1	1	1	1			
D8	1500x6600	1100x6600	1	1	1	1	1			
D9	1200x6600	1100x6600	1	1	1	1	1			
D10	1000x6600	1100x6600	1	1	1	1	1			
D11	900x6600	1100x6600	1	1	1	1	1			
D12	750x6600	1100x6600	1	1	1	1	1			
ALUMINIUM WINDOWS										
W1	1500x1700	1300x1700	1	1	1	1	1			
W2	1200x1700	1100x1700	1	1	1	1	1			
W3	1000x1700	1100x1700	1	1	1	1	1			
W4	800x1700	1100x1700	1	1	1	1	1			
W5	600x1700	1100x1700	1	1	1	1	1			
W6	400x1700	1100x1700	1	1	1	1	1			
ALUMINIUM SLIDING WINDOWS										
SW1	1500x1700	1300x1700	1	1	1	1	1			
SW2	1200x1700	1100x1700	1	1	1	1	1			
SW3	1000x1700	1100x1700	1	1	1	1	1			
SW4	800x1700	1100x1700	1	1	1	1	1			
SW5	600x1700	1100x1700	1	1	1	1	1			
SW6	400x1700	1100x1700	1	1	1	1	1			

PRE PAINTED STEEL WINDOWS										
NO	NAME	SIZE	C.F.	G.F.	1ST FLOOR	2ND FLOOR	3RD FLOOR	4TH FLOOR	5TH FLOOR	6TH FLOOR
V1	1500x1700	1300x1700	1	1	1	1	1			
V2	1200x1700	1100x1700	1	1	1	1	1			
V3	1000x1700	1100x1700	1	1	1	1	1			
V4	800x1700	1100x1700	1	1	1	1	1			
V5	600x1700	1100x1700	1	1	1	1	1			
V6	400x1700	1100x1700	1	1	1	1	1			
ALUMINIUM SLIDING WINDOWS										
SW1	1500x1700	1300x1700	1	1	1	1	1			
SW2	1200x1700	1100x1700	1	1	1	1	1			
SW3	1000x1700	1100x1700	1	1	1	1	1			
SW4	800x1700	1100x1700	1	1	1	1	1			
SW5	600x1700	1100x1700	1	1	1	1	1			
SW6	400x1700	1100x1700	1	1	1	1	1			

AREAS		
FLOOR	BUILDUP AREA	NET AREA
CELLAR FLOOR AREA	1218.00 Sqm	1218.00 Sqm
SUB CELLAR FLOOR AREA	1255.00 Sqm	1255.00 Sqm
TOTAL BASEMENT AREA	2473.00 Sqm	2473.00 Sqm
GROUND FLOOR PLAN	1200.00 Sqm	1200.00 Sqm
FIRST FLOOR PLAN	1200.00 Sqm	1200.00 Sqm
SECOND FLOOR PLAN	1200.00 Sqm	1200.00 Sqm
THIRD FLOOR PLAN	1200.00 Sqm	1200.00 Sqm
FOURTH FLOOR PLAN	910.00 Sqm	910.00 Sqm
TOTAL	5710.00 Sqm	5710.00 Sqm
PORTICO AREA	42473.00 Sqm	42473.00 Sqm
TOTAL	70.00 Sqm	70.00 Sqm

NO	REV	DATE	DESCRIPTION	CHKD BY	REFERENCE
1					

**ARCHITECTURAL WORKING DRAWING**

Project : **PROPOSED CONSTRUCTION OF GOLDEN JUBILEE BLOCK IN THE PREMISES OF MNJ INSTITUTE OF ONCOLOGY & REGIONAL CANCER CENTRE AT RED HILLS, HYDERABAD**

Client : **ANDHRA PRADESH HEALTH & MEDICAL HOUSING & INFRASTRUCTURE DEVELOPMENT CORPORATION, APJANING BUILDING, 104 & 105 CAMPUS SILTAN BAZAR, KOTI, HYDERABAD. ANDHRA PRADESH- 500095.**

Title :			
<b>PLAN OF GOLDEN JUBILEE BLOCK SUB CELLAR FLOOR PLAN</b>			

Consultants			
<b>S.S. CONSULTANTS</b>			
PROJECT CONSULTANTS #17&8, JUBBARI BUILDINGS, BECOMPET, HYDERABAD-16			
PH: 5531 0240, 5531 0954, FAX: 5531 0240, 5531 0954.			
email: sscons@redhills.com, email: sscons@redhills.com			
DATE	SCALE	DESIGNED BY	DRAWN BY
10-01-2017	N.T.S	NVS	LAKSHMI
DRG. NO. - SS/AP/HEMDC/ANV/REDHILLS/GOLDEN/AR-01 B			



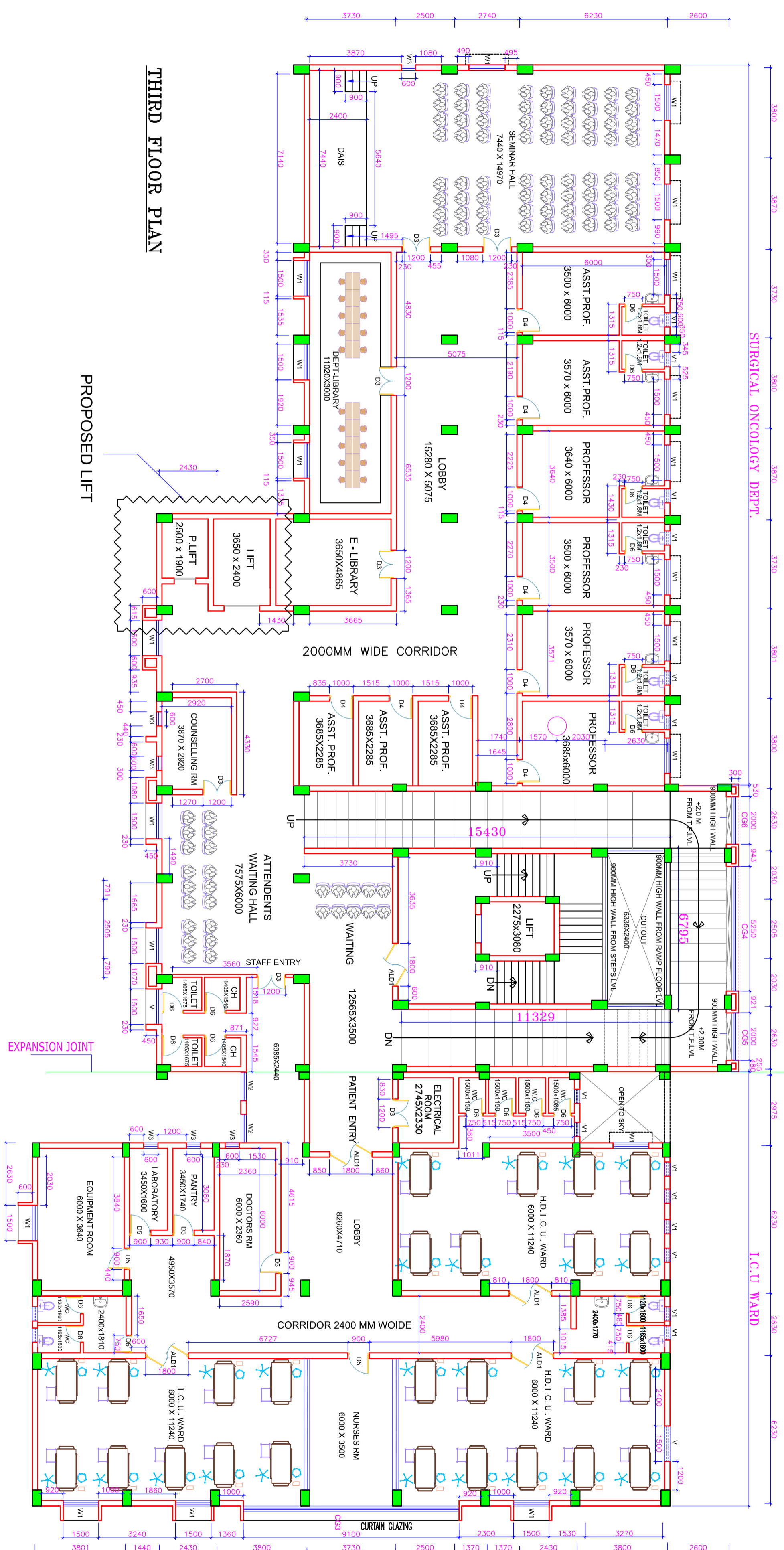

**THIRD FLOOR PLAN**

**PROPOSED LIFT**

**AREAS**

FLOOR	BUILT UP AREA	IONERARY SCHEDULE	PRE-PAINTED STEEL WINDOWS	CURTAIN GLAZING
CELLAR FLOOR AREA	1218.00 Sq.m	WAVE	WAVE	CG1A
SUB CELLAR FLOOR AREA	1255.00 Sq.m	D1	W1	CG1B
TOTAL BASEMENT AREA	2473.00 Sq.m	D2	W2	CG2
GROUND FLOOR PLAN	1200.00 Sq.m	D3	W3	CG3
FIRST FLOOR PLAN	1200.00 Sq.m	D4	W4	CG4
SECOND FLOOR PLAN	1200.00 Sq.m	D5	W5	CG5
THIRD FLOOR PLAN	1200.00 Sq.m	D6	W6	CG6
FOURTH FLOOR PLAN	1200.00 Sq.m	D7	W7	CG7
TOTAL	6000.00 Sq.m	D8	W8	CG8
PORTICO AREA	8473.00 Sq.m	D9	W9	CG9

**IONERARY SCHEDULE**

WAVE	SIZE	CG1A	CG1B	CG2	CG3	CG4	CG5	CG6	CG7	CG8	CG9
W1	1500x1700	1	1	1	1	1	1	1	1	1	1
W2	1500x1700	1	1	1	1	1	1	1	1	1	1
W3	1500x1700	1	1	1	1	1	1	1	1	1	1
W4	1500x1700	1	1	1	1	1	1	1	1	1	1
W5	1500x1700	1	1	1	1	1	1	1	1	1	1
W6	1500x1700	1	1	1	1	1	1	1	1	1	1
W7	1500x1700	1	1	1	1	1	1	1	1	1	1
W8	1500x1700	1	1	1	1	1	1	1	1	1	1
W9	1500x1700	1	1	1	1	1	1	1	1	1	1

**NOTE:**

- EXTERNAL & INTERNAL BRICKWORK TO BE IN LIGHT WEIGHT BRICKS WITH UNIT WT. NOT MORE THAN 10 KN/M<sup>2</sup>
- AS PER SITE CONDITIONS THERE ARE TOILETS ADJACENT TO RAMP WHICH WAS EXECUTED AS PER USER DEPT. REQUIREMENT.
- D/E ASKED TO PROVIDE LIFTS AS PER USER DEPT. REQUIREMENT. THE SAME IS INCORPORATED IN ALL FLOORS AT GRIDS 6C & 7C

**PROJECT :** GOLDEN JUBILEE BLOCK IN THE PREMISES OF MAIN INSTITUTE OF ONCOLOGY & REGIONAL CANCER CENTRE AT RED HILLS, HYDERABAD

**ARCHITECTURAL WORKING DRAWING**

**TITLE :** PLAN OF GOLDEN JUBILEE BLOCK PROPOSED THIRD FLOOR PLAN

**CLIENT :** TELANGANA MEDICAL SERVICES  
INFRASTRUCTURE DEVELOPMENT CORPORATION  
(An Enterprise of Government of Telangana)  
DM & HS CAMPUS  
SUL TAN BAZAR, KOTI, HYDERABAD.

**APPROVED**  
AD/- DT : 09.10.2017  
CHIEF ENGINEER (TMSIDC)  
HYDERABAD

**DATE :** 09.10.17  
**SCALE :** N.T.S  
**DEALT BY :** M.GANESH  
**DESIGNED BY :** A.V.LAKSHMI  
**PRINCIPAL CONSULTANT :** S.S. RAO

**SHEET NO.:** 04

**CONSULTANTS :** S.S. CONSULTANTS  
PROJECT CONSULTANTS  
#17&9, JABBAR BUILDINGS,  
BEGLUMPET, HYDERABAD-16  
PH: 66310240, 66310954,  
FAX NO: 040-66312949.  
emil: sscnss3699@gmail.com

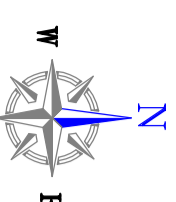

COPY RIGHT OF THIS DRAWING BELONGS TO M/S S.S. CONSULTANTS AND SHOULD NOT BE USED FOR ANY PURPOSE OTHER THAN SPECIFIED WITHOUT PRIOR PERMISSION.